

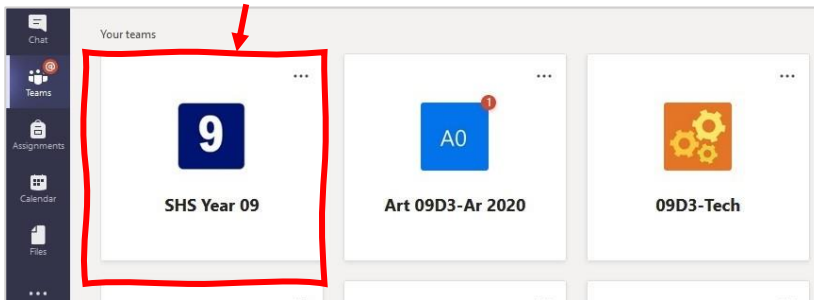

Completing the morning register

It is vital that all students complete the morning register before 10am each day. To register your attendance:

1. Open **Teams**
2. Go to your **Year Group Team**



3. Your Year Leader will post a link to the register every day in the Year posts.

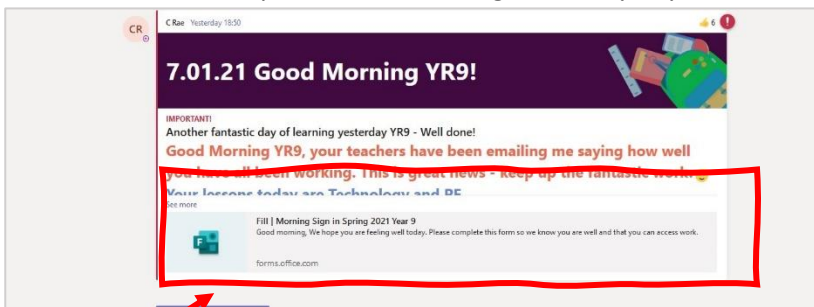

4. Click the **link**.

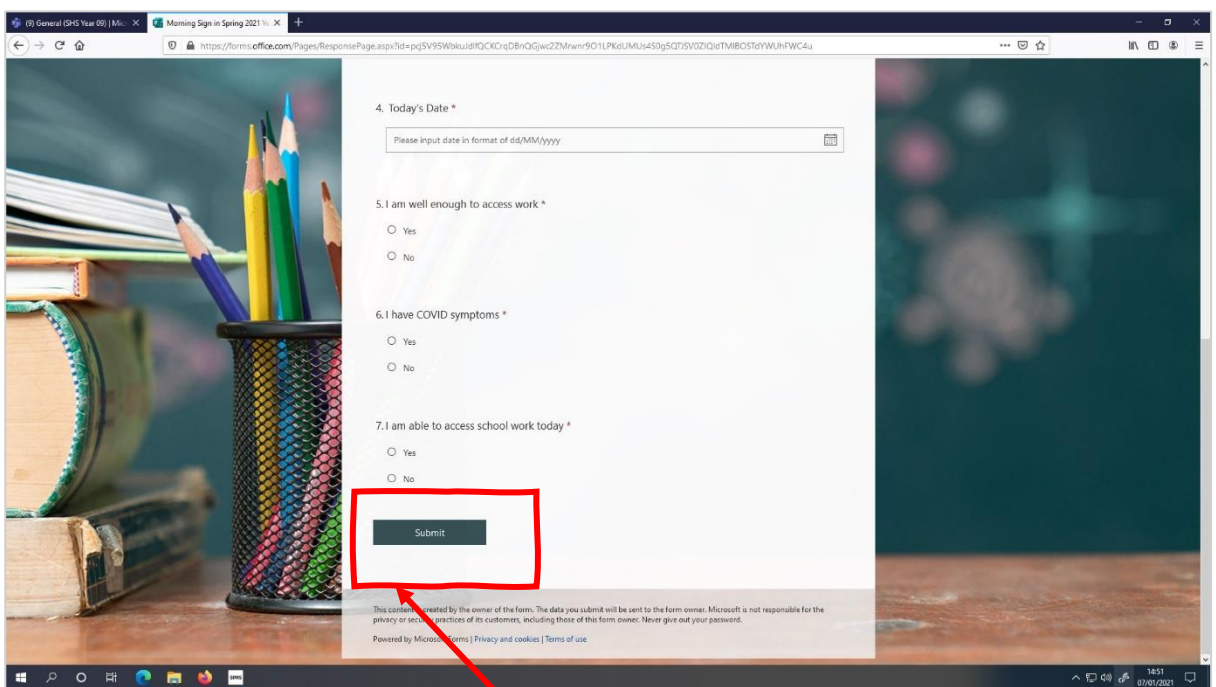

5. Complete the form. Don't forget to click "**Submit**" or you will not be registered.